

Rigging, the above are recommended sizes and materials.

Notes: alternative holes are permitted in the Boom for the pin securing the tack of the Mainsail.

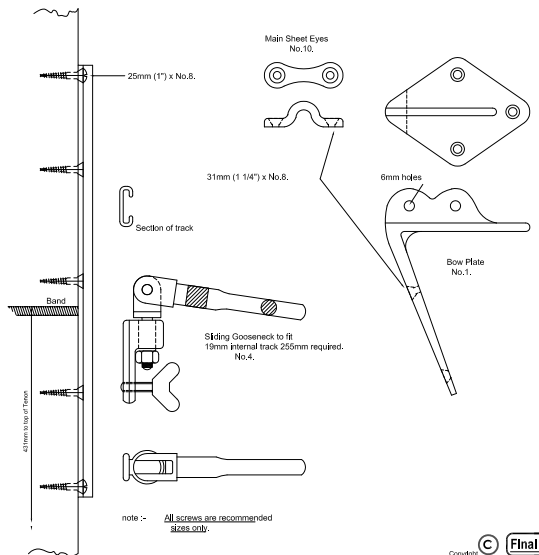

note -> All screws are recommended sizes only.

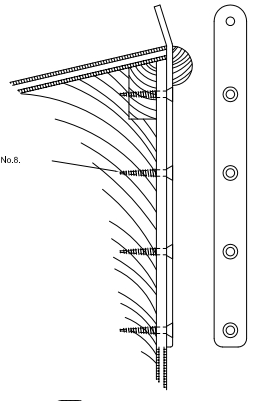
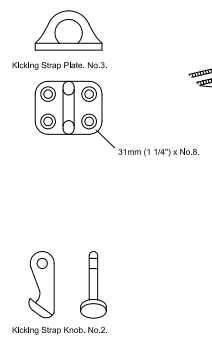
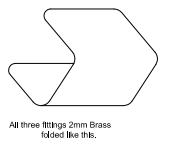
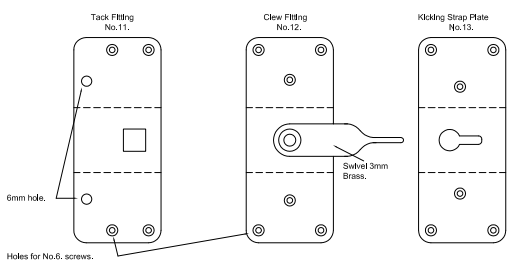
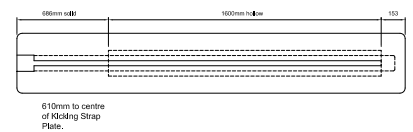
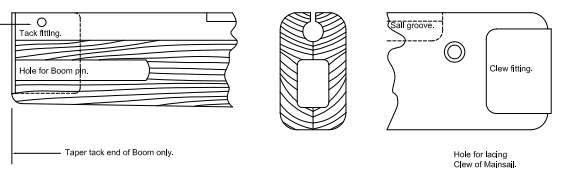
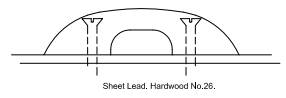
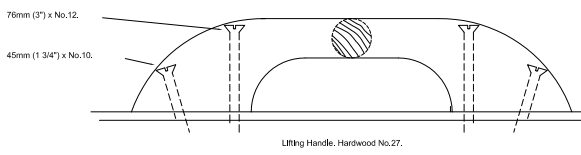

DO NOT SCALE
 THE DIMENSIONAL ACCURACY OF THIS PRINT MAY VARY DUE TO ATMOSPHERIC CONDITIONS AND REPRODUCTION METHODS
 IT IS RECOMMENDED THAT FORMERS ARE CHECKED AGAINST THE MEASUREMENT FORM BEFORE COMMENCING CONSTRUCTION

Lifting handle is optional but if used of this design Fitting shall comply to International Enterprise Class Rule 6.

INTERNATIONAL ENTERPRISE CLASS RULE No.1

OBJECT OF THE CLASS RULES
 this is a one design class. The Rules, Plans, and Specifications are intended to ensure that in the hull form, weight, scantlings, sail colour, deck plan, the boats are as nearly alike as possible with variations in cockpit layout and fittings as alternatives on lists and plans. All boats shall be built according to the plans and rules in all respects.

Author	INTERNATIONAL SAILING FEDERATION
Class	ARIADNE HOUSE, TOWN QUAY, SOUTHAMPTON, SO14 2AQ
Designer	INTERNATIONAL ENTERPRISE
Scale	FULL SIZE (1:1)
Sheet	SHEET 8
Title	WOODEN MAST AND BOOM, FITTINGS, AND RIGGING.
Drawn	REDRAWN AUTOCAD 14
Checked	REDRAWN
Scale	SIRD JAN 2000 103
Date	RJR MARCH 1974
By	tdc
Scale	

Copyright © Final Issue 12/01/01